

# Instructor Control Guide

## 1. Door Mirror Controls

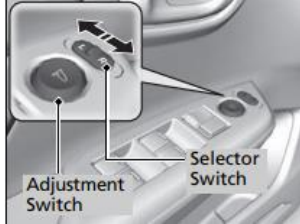

## 6. Heating, Cooling, Climate Control, Front and Rear, Defrosters

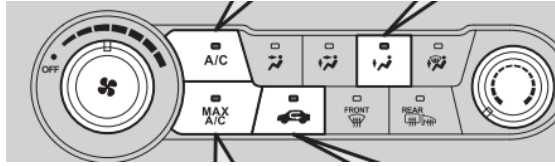

(Windshield Defroster) Button -  
 (Rear Window Defogger/ Heated Mirror) Button

## 2. Turn Signals and Light Switches

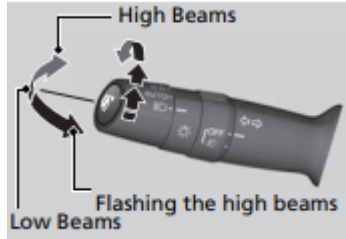
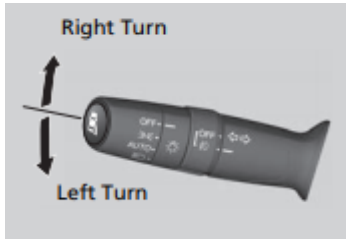

## 7. Hazard Lights

(4 Way Flashers/Emergency Lights)



## 3. Wipers and Washer Fluid

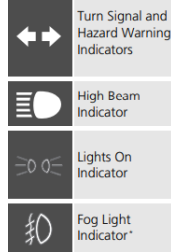
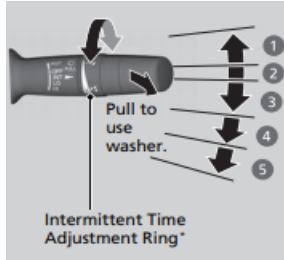

## 8. Emergency/Parking Brake

## 9. Automatic Transmission Shifting

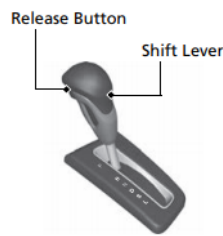

**P**ark  
**R**everse  
**N**eutral  
**D**rive  
**L**ow



## 4. Horn

## 5. Ignition (Switch OR Start/Stop Button)

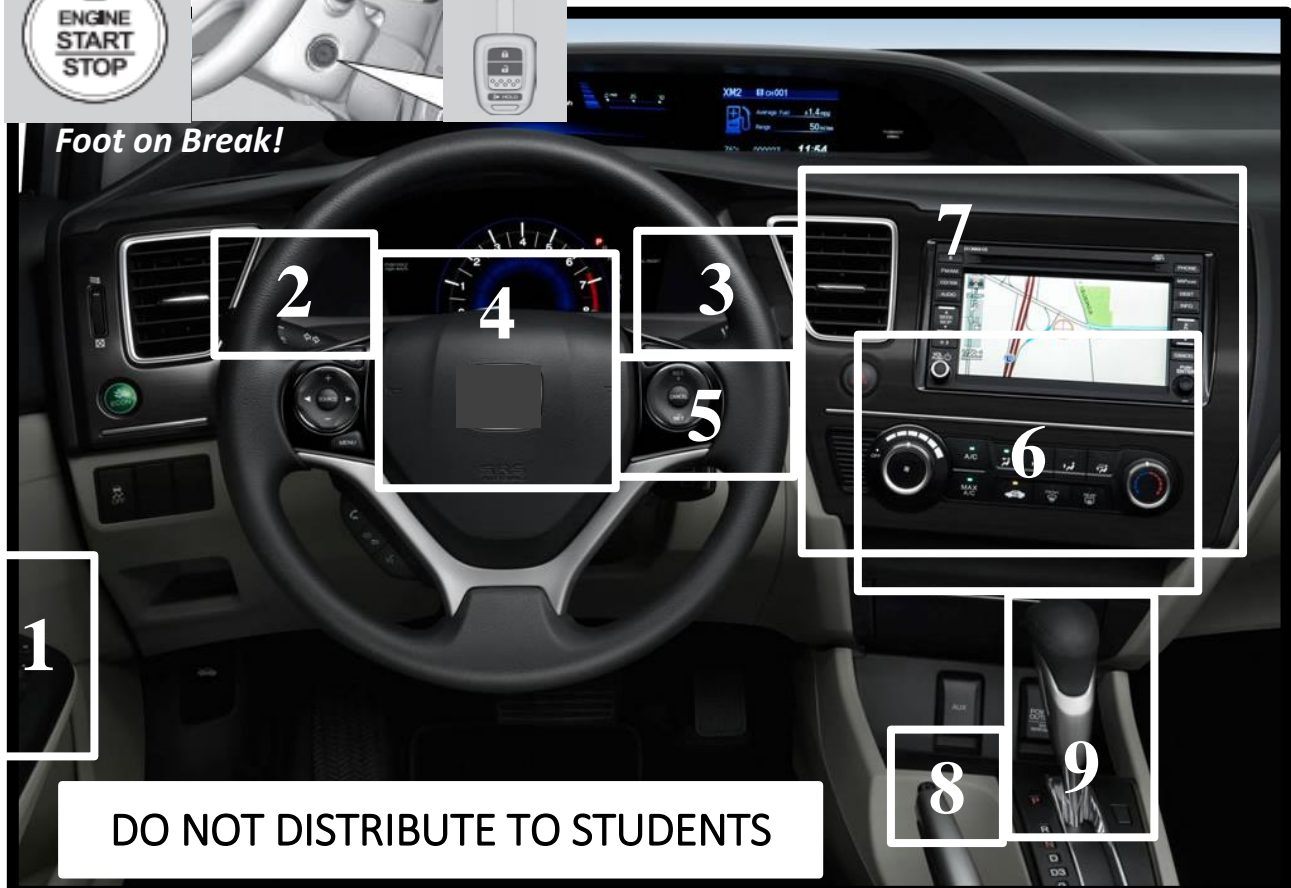

**Foot on Break!**

DO NOT DISTRIBUTE TO STUDENTS